



www.samhongsa.com

SHS SAMHONGSA

Head Office in Korea
 #1201~9, Daeryung TechnoTown 12th, 14, Gasan Digital 2-ro,
 Geumcheon-gu, Seoul, 08592, Korea.
 Tel: +82-2-3282-5331 Fax: +82-2-3282-5395

Sihwa Factory in Korea
 #715, 4-ma, Sihwa Industrial Complex, Beonyeong-ro, Danwon-gu,
 Ansan-si, Gyeonggi-do, 15415, Korea.
 Tel: +82-31-434-8531 Fax: +82-31-434-8535

Qingdao Factory in China (QINGDAO SAMHONG PRECISION INSTRUMENT CO.,LTD)
 No.3 Hetouyuan Industrial Area, JiaoZhou, QingDao, 266300, China.
 Tel: +86-532-8662-7058 Fax: +86-532-8662-7063

Guangzhou Factory in China (GUANGZHOU SAMHONG FURNITURE ACCESSORIES CO., LTD)
 Wujinzonghezongchang, Jiucunnan Road, Jiushuikeng Town, Panyu District, Guangzhou City, Guangdong Province, 511450, China.
 Tel: +86-20-3488-5146 Fax: +86-20-3488-5183

본사
 서울특별시 금천구 가산디지털2로 14 대륭테크노타운
 12차, 1201~9호 (우: 08592)
 Tel : 02-3282-5331 Fax : 02-3282-5395

시화공장
 경기도 안산시 단원구 변영로 67 시화공단 4마 715호 (우: 15415)
 Tel : 031-434-8531 Fax : 031-434-8535

青岛三弘精密器械有限公司
 青岛胶州市杭州西路河头源工业区3号
 邮编: 266300 Tel: 0532-8662-7058 Fax: 0532-8662-7063

广州三弘家具配件有限公司
 广州市番禺区石基镇旧水坑村旧村南路五金综合总厂A座
 邮编: 511450 Tel: 020-3488-5146 Fax: 020-3488-5183



How to choose a
 Good Gas Cylinder?
 Scan this QR Code



WIPER
 Clean Surface Always

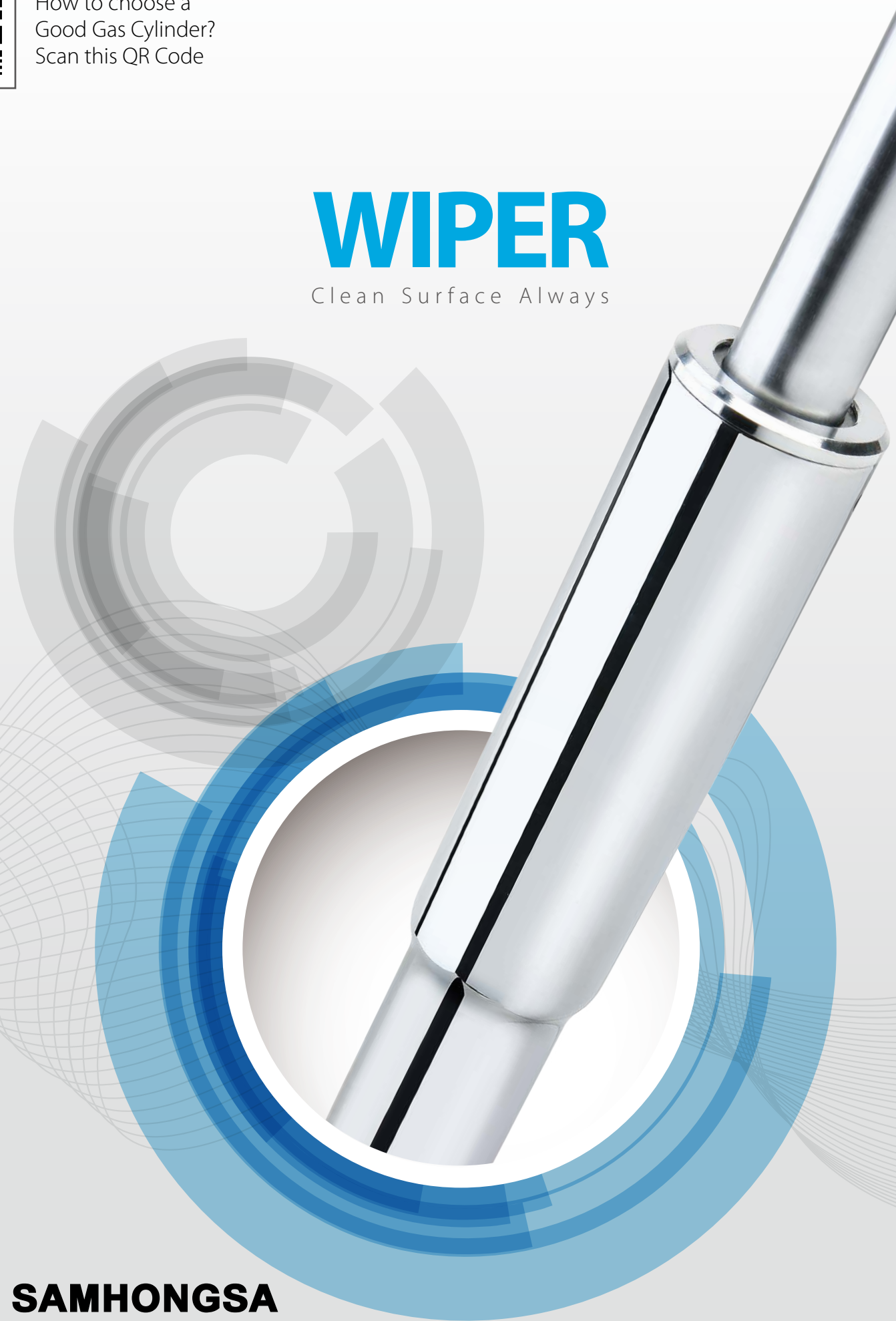

SHS SAMHONGSA
 THE GAS CYLINDER

Samhongsas HISTORY

- Found Samhongsas Co., Ltd. (President : Mr. Min Byung Sung) **1970. 02**
 - Gas Cylinder and Spring business started in KOREA **1992. 03**
 - New factory was built up in Qingdao CHINA **1996. 07**
 - QS 9000 Quality System Certificate **1998. 12**
 - Min Woo Kee inaugurated as the new CEO **2014. 10**
- 1987. 12** Established Samhongsas R&D institute
 - 1994. 06** ISO 9001 Quality Management System Certificate
 - 1997. 12** QS 9000 Quality System Certificate
 - 2003. 01** New factory was built up in Guangzhou China

Samhongsas LOCATION

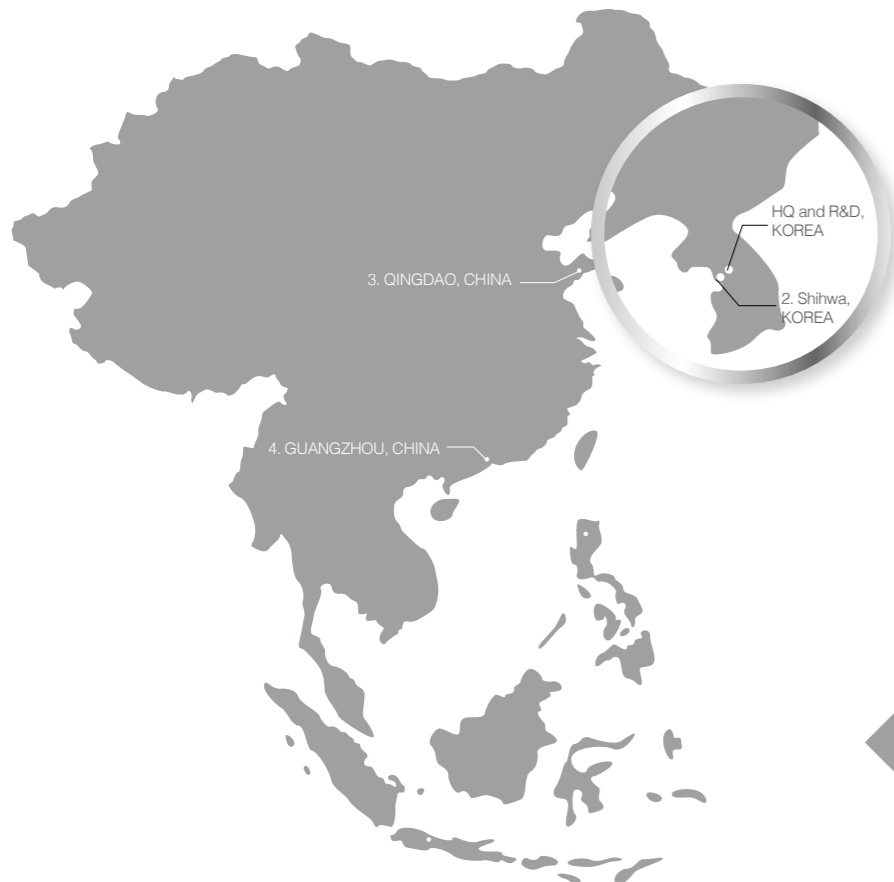

SHS SAMHONGSAS

1. HQ and R&D Institute
2. Shihwa Factory
3. Qingdao Factory
4. Guangzhou Factory & Sales Office

Samhongsas CODE SYSTEM

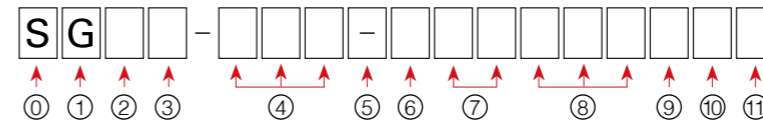

- ① SAMHONGSAS INITIAL
- ① GAS CYLINDER INITIAL
- ② TYPE
 - ❖ A: A-TYPE CYLINDER
 - ❖ B: REGULAR TYPE CYLINDER
 - ❖ D: CARTRIDGE CYLINDER
 - ❖ F: FULL STROKE CYLINDER
 - ❖ G: SINGLE STAGE CYLINDER
 - ❖ H: HEAVY DUTY CYLINDER
 - ❖ J: JOYSTICK CYLINDER
 - ❖ L: AUTO-RETURN LIFT CYLINDER
 - ❖ N: NON-ROTATED CYLINDER
 - ❖ P: PLUS CYLINDER
 - ❖ R: AUTO-RETURN CYLINDER RETURN CYLINDER
 - ❖ S: CABLE ACTIVATED CYLINDER
 - ❖ T: 2-STAGE CYLINDER
 - ❖ U: AUTO LIFT CYLINDER
 - ❖ W: WIPER CYLINDER
 - ❖ X: BOUNCING CYLINDER
 - ❖ Y: FIXED HEIGHT CYLINDER
 - ❖ Z: NEW NON-ROTATED CYLINDER
- ③ SPINDLE PIPE
 - ❖ 1, 3, 7: WITHOUT LARGE PIPE
 - ❖ 2, 4, 8: WITH LARGE PIPE
- ④ STROKE (FULL)
 - A2L: LEVERTYPE
 - B2E: DEEP CUSHION
 - B2K: SOFT LANDING
 - B2S: SILENT DRIVING
 - N2L: DUAL MODE
 - U2R: AUTO RETURN LIFT
 - U2N: NON-ROTATED AUTO LIFT
- ⑤ COMBINATION
 - A2L: LEVERTYPE
 - B2E: DEEP CUSHION
 - B2K: SOFT LANDING
 - B2S: SILENT DRIVING
 - N2L: DUAL MODE
 - U2R: AUTO RETURN LIFT
 - U2N: NON-ROTATED AUTO LIFT
- ⑥ LARGE PIPE DIAMETER
 - ❖ -: SPINDLE ONLY
 - ❖ 1: LARGE PIPE (D40)
 - ❖ 2: LARGE PIPE (D45)
 - ❖ 3: LARGE PIPE (D38)
 - ❖ 4: LARGE PIPE (D50)
 - ❖ 5: LARGE PIPE (D50.8)
 - ❖ 7: LARGE PIPE (D50)
 - ❖ 9: LARGE PIPE (D50)
- ⑦ GAS PRESSURE
 - ❖ UNIT: kgf (kgf x 9.8 = Newton)
- ⑧ LARGE PIPE LENGTH
 - ❖ UNIT: mm
- ⑨ SPINDLE FINISH
 - ❖ C: CHROME PLATING
 - ❖ B: BLACK (Heat Treatment)
 - ❖ W: WHITE (Heat Treatment)
 - ❖ S: SHINY (HEAT TREATMENT)
- ⑩ LARGE PIPE FINISH
 - ❖ C: CHROME PLATING
 - ❖ E: ELECTRO COATING
 - ❖ H: BRUSHED CHROME PLATING
 - ❖ B: BLACK PAINTING
 - ❖ T: TEXTURED BLACK PAINTING
 - ❖ G: GRAY PAINTING
 - ❖ S: SILVER PAINTING
 - ❖ W: WHITE PAINTING
- ⑪ SERIAL No.
 - ❖ A, B, C, D, ..., Z

Internal System

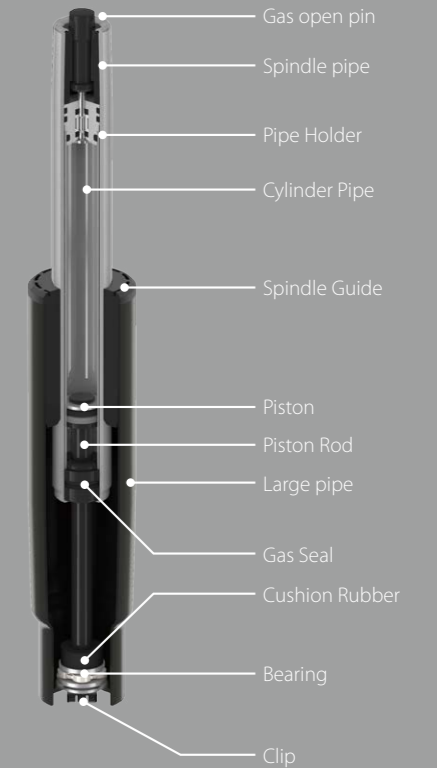

Samhongsas CERTIFICATE



DIN EN 16955-2017 CLASS 4



DIN EN 16955-2017 CLASS 3

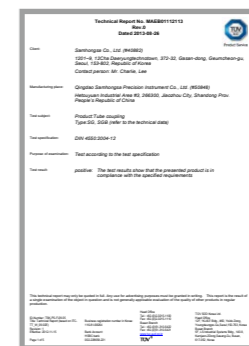

TUV TEST REPORT



ISO 14001



ISO 9001

Samhongs
Standard Cylinder



◆ **Features**

- Meets DIN EN 16955-2017 Class 3, 4 and all applicable ANSI/ BIFMA, EN performance standards.
- Customized color gas open pin and pressurization are available from 150N to 500N.
- Standard 40mm, 45mm and 50mm large pipes are available.
- Heat treated and Chrome plated spindle pipes are available.
- Powder coated, E-coated and Chrome plated large pipes are available.
- Spindle only type is available.

◆ **Application**

- General office chair.

◆ **Advantages**

- Flexible upon request.

◆ **Dimensions**

- Available for all chair types, dimensions upon request.

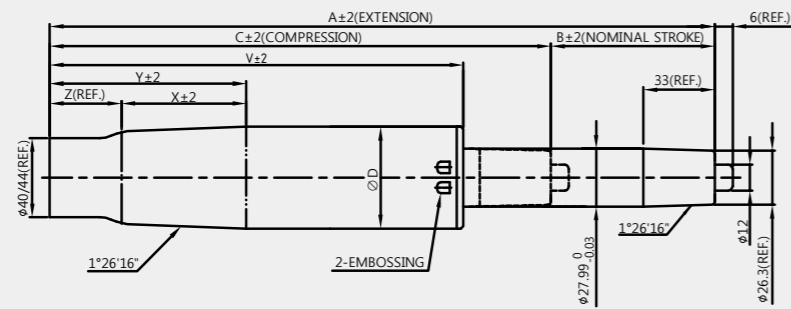

LARGE PIPE : DOUBLE CONE

◆ **SGB2 TYPE**

MODEL	DIMENSION(mm)								
	A	B	C	D(Φ)	V	Y	X	Z	F1(N)
SGB2-076-440170BBA	283	68	215	50	170	100	56	44	400
SGB2-080-440185BBC	317	76	241	50	185	108	56	52	400
SGB2-088-440185BBB	309	80	229	50	185	97	56	41	400
SGB2-100-435197BBC	349	92	257	50	197	75	56	19	350
SGB2-100-440200BBC	349	92	257	50	200	98	56	42	400
SGB2-104-440195BBD	345	96	249	50	195	98	56	42	400
SGB2-104-540195BBA	345	96	249	50.8	195	115	56	59	400
SGB2-110-430203CBA	347	102	245	50	203	106	56	50	300
SGB2-116-435215CBA	369	108	261	50	215	165	56	109	350
SGB2-116-440195BBA	351	108	243	50	195	148	56	92	400
SGB2-116-940192BBB	381	112	269	50	192	98	56	42	400

◆ **SGB2 TYPE**

MODEL	DIMENSION(mm)								
	A	B	C	D(Φ)	V	Y	X	Z	F1(N)
SGB2-119-430210CBA	375	115	260	50	210	85	56	29	300
SGB2-120-430210BBA	367	112	255	50	210	70	56	14	300
SGB2-120-430215BBB	384	112	272	50	215	97	56	41	300
SGB2-120-440207BBA	373	117.5	255.5	50	207	93	56	37	400
SGB2-120-935203CBA	357.5	108.5	249	50	203	100	56	44	350
SGB2-125-430205CBA	371	117	254	50	205	135	56	79	300
SGB2-125-435215CBD	397	117	280	50	215	148	56	92	350
SGB2-125-930215BBA	378	121	257	50	215	159	56	103	300
SGB2-128-430225BBA	400.5	120.5	280	50	225	142	56	86	300
SGB2-130-430215BBA	386	122	264	50	215	97	56	41	300
SGB2-130-430230CBA	406	122	284	50	230	158	56	102	300
SGB2-133-430215BBA	394	125	269	50	215	165	56	109	300
SGB2-133-435215BBB	392	129	263	50	215	135	56	79	350
SGB2-138-430215BBB	399.5	126.5	273	50	215	155	56	99	300
SGB2-138-430230BBB	418	130	288	50	230	175	56	119	300
SGB2-138-430250BBA	441	130	311	50	250	121	56	65	300
SGB2-140-430230BBC	416	132	284	50	230	125	56	69	300
SGB2-140-430232BBA	416	132	284	50	232	98	56	42	300
SGB2-143-430223BBB	412	135	277	50	223	101	56	45	300
SGB2-143-430235BBB	415	135	280	50	235	98	56	42	300
SGB2-143-430237BBC	421	135	286	50	237	75	56	19	300
SGB2-143-435235BBA	412	135	277	50	235	75	56	19	350
SGB2-143-440230BBC	415	139	276	50	230	72	56	16	400
SGB2-144-940230BBA	426	140	286	50	230	98	56	42	400
SGB2-148-430230CBA	426	132	294	50	230	75	56	19	300
SGB2-183-430307BBA	532	175	357	50	307	86	56	30	300
SGB2-200-435290BBA	535	192	343	50	290	80	56	24	350
SGB2-200-440313BBA	574	192	382	50	313	75	56	19	400
SGB2-200-935365BBA	611	196	415	50	365	78	56	22	350
SGB2-210-435305CCA	554	202	352	50	305	100	56	44	350
SGB2-220-440388BBA	674	212	462	50	388	137	56	81	300
SGB2-238-935335SBA	634.5	230.5	404	50	335	80	56	24	350
SGB2-270-535355BBA	693	262	431	50.8	355	101	70	31	350

◆ **SGB4 TYPE**

MODEL	DIMENSION(mm)								
	A	B	C	D(Φ)	V	Y	X	Z	F1(N)
SGB4-078-440155CBA	285	70	215	50	155	74	56	18	400
SGB4-080-440177CBA	306	72	234	50	177	95	56	39	400
SGB4-080-440185CCB	306	72	234	50	185	120	56	64	400
SGB4-088-440173CBA	295	80	215	50	173	95	56	39	400
SGB4-088-440185CBF	314	80	234	50	185	97	56	41	400
SGB4-094-445190CBA	325	86	239	50	190	123	56	67	450
SGB4-100-440185CBA	349	92	257	50	185	95	56	39	400
SGB4-100-535215CBA	351	92	259	50.8	215	90	56	34	350
SGB4-104-435190CBA	335	100	235	50	190	100	56	44	350
SGB4-104-530185BBA	328	100	228	50.8	185	98	56	42	300
SGB4-108-440200CBA	349	92	257	50	200	72	56	16	400
SGB4-110-530202BBA	349	106	243	50.8	202	147	56	91	300
SGB4-116-440210BBA	363	108	255	50	210	148	56	92	400
SGB4-120-430215CBA	384	112	272	50	215	82	56	26	300
SGB4-120-435215BBA	398	112	286	50	215	85	56	29	350
SGB4-123-530215BBA	372	119	253	50.8	215	110	56	54	300
SGB4-108-440200CBA	349	92	257	50	200	72	56	16	400
SGB4-110-530202BBA	349	106	243	50.8	202	147	56	91	300
SGB4-116-440210BBA	363	108	255	50	210	148	56	92	400
SGB4-120-430215CBA	384	112	272	50	215	82	56	26	300
SGB4-120-435215BBA	398	112	286	50	215	85	56	29	350
SGB4-123-530215BBA	372	119	253	50.8	215	110	56	54	300
SGB4-128-435212CBA	375	120	255	50	212	100	56	44	350
SGB4-135-530215BBA	384	127	257	50.8	215	97	56	41	300
SGB4-143-430232CBA	430	135	295	50	232	88	56	32	300
SGB4-143-435220CBA	421	135	286	50	220	80	56	24	350

Samhongs
Standard Cylinder

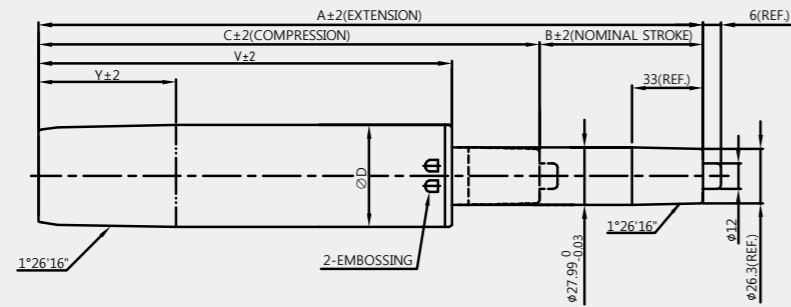

LARGE PIPE : SINGLE CONE

◆ SGB2 TYPE

MODEL	DIMENSION(mm)						
	A	B	C	D(Φ)	V	Y	F1(N)
SGB2-094-435180CBA	325	86	239	50	180	65	350
SGB2-100-435195BBA	349	92	257	50	195	60	350
SGB2-104-435195BBA	355	96	259	50	195	75	350
SGB2-108-440195CBA	355	100	255	50	195	70	400
SGB2-120-435228BBA	384	112	272	50	228	58	350
SGB2-128-435230CBA	397	120	277	50	230	70	350
SGB2-140-430235BCA	416	132	284	50	235	65	300
SGB2-143-435237BBA	412	135	277	50	237	58	350
SGB2-160-430255BCA	471	152	319	50	255	80	300
SGB2-200-430305CBA	552	192	360	50	305	65	300
SGB2-230-435337CBA	604	222	382	50	337	80	350
SGB2-270-430375CBA	693	262	431	50	375	65	300
SGB4-128-435225CBA	400	120	280	50	225	80	350
SGB4-143-435215CBB	412	135	277	50	215	65	350
SGB4-143-435215CCA	412	135	277	50	215	65	350

◆ SGB4 TYPE

MODEL	DIMENSION(mm)						
	A	B	C	D(Φ)	V	Y	F1(N)
SGB4-060-440150CBA	245	52	193	50	150	80	400
SGB4-060-440165CBA	262	52	210	50	165	60	400
SGB4-065-440155CBA	286	57	229	50	155	49	400
SGB4-070-435167BBA	277	62	215	50	167	80	350
SGB4-076-430165CCA	283	68	215	50	165	78	300
SGB4-080-440170CBA	306	72	234	50	170	50	400
SGB4-100-440185CBC	349	92	257	50	185	70	400
SGB4-108-430195CBA	355	100	255	50	195	70	300
SGB4-108-440185BBA	349	92	257	50	185	70	400
SGB4-125-427215CBA	394	117	277	50	215	49	270
SGB4-125-430215CBA	394	117	277	50	215	65	300
SGB4-125-435205BBA	384	117	267	50	205	72	350
SGB4-128-435225CBA	400	120	280	50	225	80	350
SGB4-143-435215CBB	412	135	277	50	215	65	350
SGB4-143-435215CCA	412	135	277	50	215	65	350



BLACK
 CHROME



BLACK
 CHROME

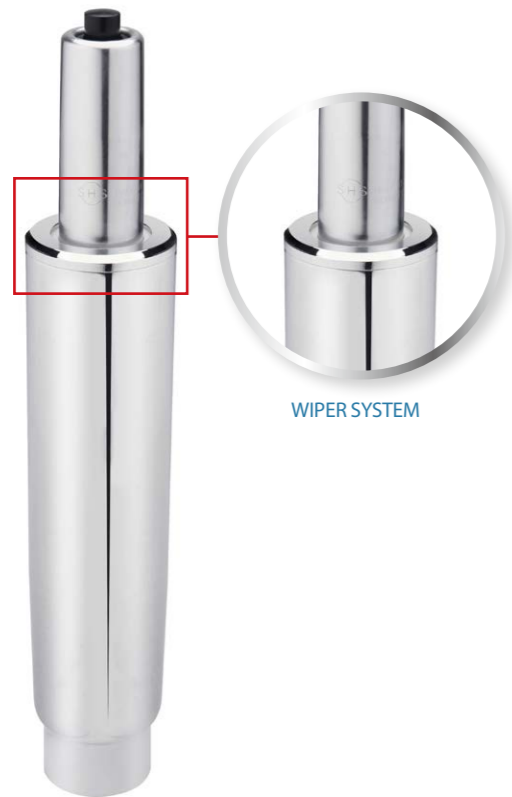

- ◆ **Features**
 - Very little grease on the surface of spindle pipe.
- ◆ **Application**
 - Conference chairs.
 - Visitors chairs.
 - Clean room.
 - Bar chairs.
- ◆ **Advantages**
 - Always maintains clean surface.
- ◆ **Dimensions**
 - Available for all chair types, dimensions upon request.

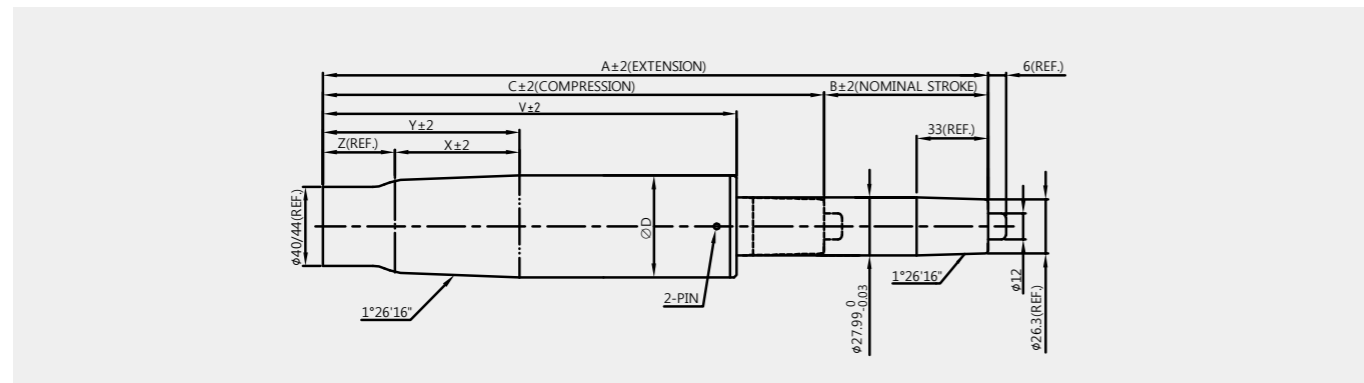

◆ **SGW2 TYPE**

MODEL	DIMENSION(mm)						
	A	B	C	D(Φ)	V	Y	F1(N)
SGW4-140-430235BCA	416	132	284	50	235	70	300
SGW2-114P430195CSA	360	110	250	50	195	133	300
SGW2-130P440208BBA	376	122	254	50	208	111	400
SGW2-148P435230CCA	437	140	297	50	230	65	350
SGW2-200-435313CCA	569	196	373	50	313	65	350
SGW2-200-435317BBA	572	196	376	50	317	70	350
SGW2-270-430370BBA	702	254	448	50	370	65	300



WHITE

LIGHT GREY

BEIGE

MODEL	DIMENSION(mm)
Color Wiper	• Customized color (RAL, NCS standards) and size available upon request

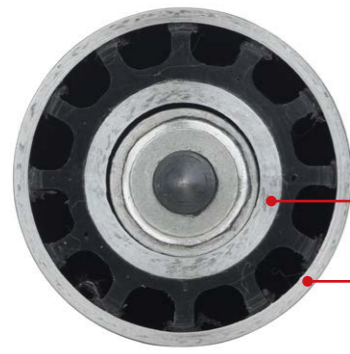

- ◆ **Features**
 - Enhanced spindle pipe and large pipe.
 - Double Seal System.
- ◆ **Application**
 - Chairs for intensive 24 hour use.
 - Chairs for heavy load.
- ◆ **Advantages**
 - Enhanced structures enable heavy and intensive usage of chairs.
- ◆ **Dimensions**
 - Available for all chair types, dimensions upon request.
 - 50mm large pipe diameter.

SPINDLE PIPE : 3.0t

LARGE PIPE : 2.0t

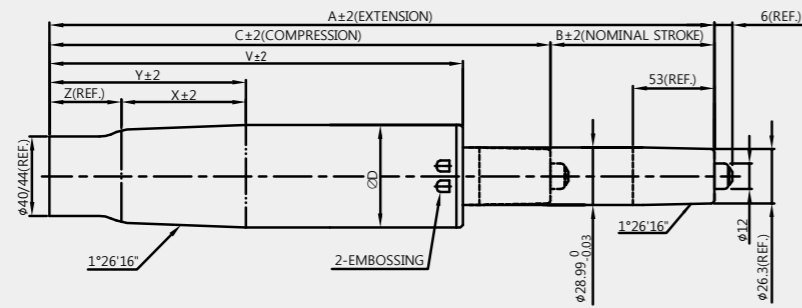

◆ **SGH8 TYPE**

MODEL	DIMENSION(mm)								
	A	B	C	D(Φ)	V	Y	X	Z	F1(N)
SGH8-088-945185BBA	315.5	76.5	239	50	185	110	56	54	450
SGH8-094-945168BBA	303.5	88	215	50	168	101	56	45	450
SGH8-100-945187SBA	334	96	238	50	187	100	56	44	450
SGH8-114-940185SBA	340	110	230	50	185	100	56	44	400
SGH8-114-945205BBA	361	110	251	50	205	94	56	38	450
SGH8-130-945215BBA	385.5	116.5	269	50	215	97	56	41	450
SGH8-200-945315BBA	573.5	192.5	381	50	315	100	56	44	450
SGH8-270-945365BBA	698.5	254.5	444	50	365	105	56	49	450
SGH8-130S945195BBA	385.5	118.5	267	50	195	97	56	41	450
SGH8-170S945245BBA	470	162	308	50	245	98	56	42	450

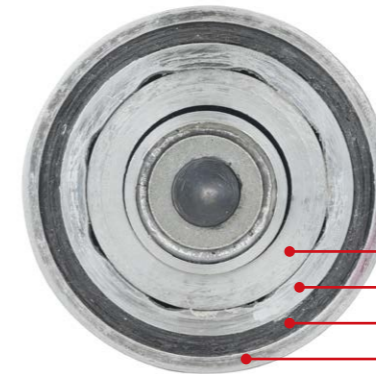

- ◆ **Features**
 - Enhanced spindle pipe and large pipe.
 - Double Seal System.
 - Extensive range of stroke in a relatively short length of large pipe.
- ◆ **Application**
 - Chairs for intensive 24 hour use.
 - Chairs for heavy load.
- ◆ **Advantages**
 - Enhanced structures enable heavy and intensive usage of chairs.
 - Wobble free operating.
 - Extensive range of stroke.
- ◆ **Dimensions**
 - Available for all chair types, dimensions upon request.
 - 50mm large pipe diameter.

STEEL SLEEVE

STEEL BUSHING

SPINDLE PIPE : 3.0t

STEEL SLEEVE

STEEL BUSHING

LARGE PIPE : 2.0t

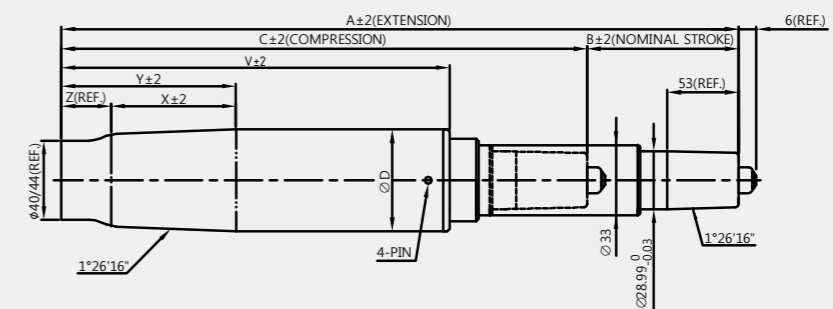

◆ **SGH8S TYPE**

MODEL	DIMENSION(mm)								
	A	B	C	D(Φ)	V	Y	X	Z	F1(N)
SGH8-076S940160BBA	304	68	236	50	160	110	56	54	400
SGH8-100S940200CBA	372	92	280	50	200	75	56	19	400
SGH8-104S940195BBA	366	96	270	50	190	155	56	99	400
SGH8-130S945195BBA	386	119	267	50	195	97	56	41	450
SGH8-148S940230CBA	440	132	308	50	230	75	56	19	400
SGH8-170S945245BBA	470	162	308	50	245	98	56	42	450

Auto Return Cylinder (Non-adjustable height)



◆ Features

- Non-adjustable height
- No gas cushion.
- Automatically returns to the original chair direction.
- Simple spring-return action design.

◆ Application

- Conference chairs.
- Visitors chairs.
- Bar and game room chairs.

◆ Advantages

- Always keeping original position.

◆ Dimensions

- Available for all chair types, dimensions upon request.
- 45mm, 50mm large pipe diameter.

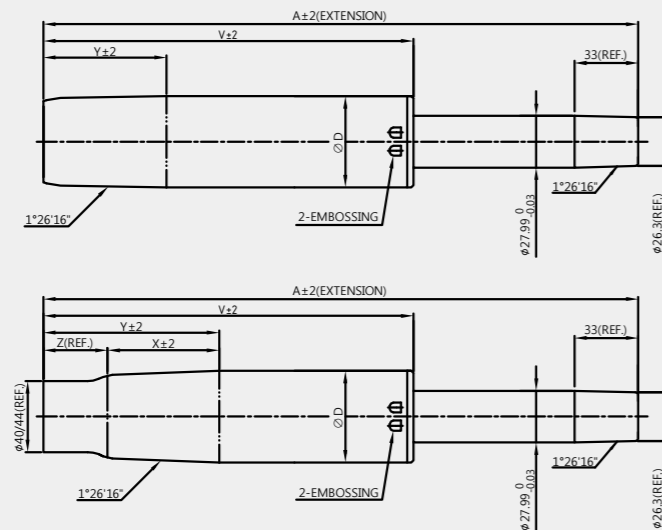

LARGE PIPE : SINGLE CONE

LARGE PIPE : DOUBLE CONE

◆ SGR TYPE

MODEL	DIMENSION(mm)				
	A	D(ϕ)	V	Y	X
SGR-013-200280CCA	360	45	260	67	-
SGR-013-400177CBA	254	50	177	78	56
SGR-013-400180CCA	254	50	180	65	-
SGR-013-400215BCA	298	50	215	65	-
SGR-013-400230CBA	280	50	230	70	56
SGR-013-400255CCA	371	50	255	51	-
SGR-013-400275CBA	335	50	275	70	-
SGR-013-500210BBB	266	50.8	210	95	56



Auto Return Cylinder



◆ Features

- Height adjustable with gas cushion.
- Automatically returns to the original chair direction.
- Simple spring-return action design.

◆ Application

- Conference chairs.
- Visitors chairs.
- Bar and game room chairs.

◆ Advantages

- Always keeping original position.
- Comfort by gas cushion

◆ Dimensions

- Available for all chair types, dimensions upon request.
- 50mm large pipe diameter.

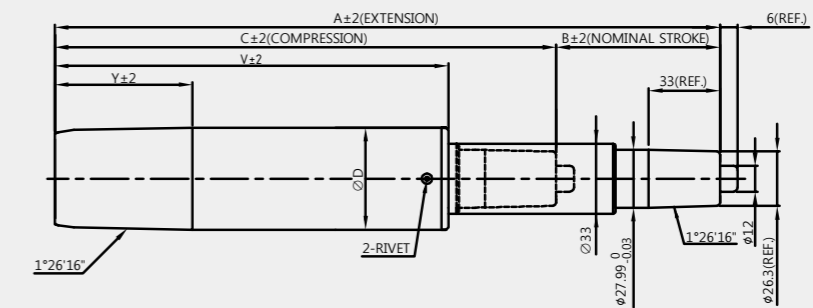

◆ SGR2 TYPE

MODEL	DIMENSION(mm)						
	A	B	C	D(ϕ)	V	Y	F1(N)
SGR2-060-440185CBB	283	68	215	50	185	65	400
SGR2-080-440205CBA	329	72	257	50	205	65	400
SGR2-080-440205CBE	329	72	257	50	205	65	400
SGR2-100-440225CCA	369	92	277	50	225	65	400
SGR2-125-435245BBA	412	117	295	50	245	65	350
SGR2-138-430250BBB	422	130	292	50	250	125	300



- ◆ **Features**
 - Optional gas cushion.
 - Automatically keeps maximum extended height.
 - Height adjustable swivel version is available.
- ◆ **Application**
 - Conference chairs.
 - Visitors chairs.
 - Bar and game room chairs.
- ◆ **Advantages**
 - Optional functions upon request.
- ◆ **Dimensions**
 - Available for all chair types upon request.

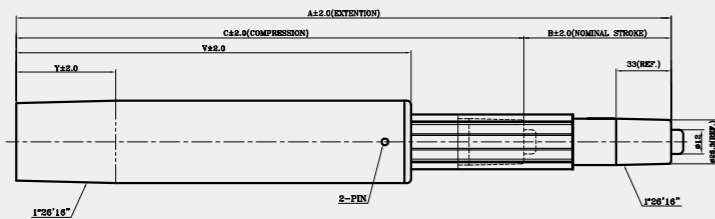

LARGE PIPE : SINGLE CONE

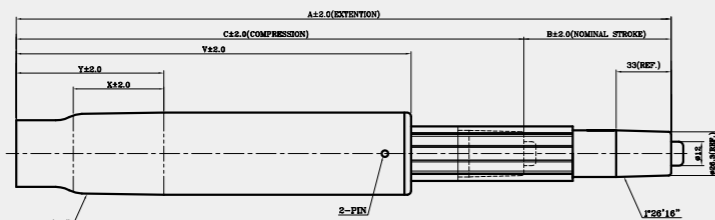

LARGE PIPE : DOUBLE CONE

◆ **SGU2 TYPE**

MODEL	DIMENSION(mm)								
	A	B	C	D(Φ)	V	Y	X	Z	F1(N)
SGU2-040F440142BBA	209	16	193	50	142	60	-	-	400
SGU2-045-230160CCA	292	29	263	45	160	68	-	-	300
SGU2-065-440215BBA	302	25	277	50	215	60	-	-	400
SGU2-072-435215BBA	341	24	317	50	215	135	56	79	350



- ◆ **Features**
 - Height adjustable.
 - Automatically returns to the original position and then returns to the highest seat position.
 - Auto return function by gas pressure.
- ◆ **Application**
 - Conference chairs.
 - Visitors chairs.
 - Bar and game room chairs.
- ◆ **Advantages**
 - Always keeping original position.
- ◆ **Dimensions**
 - Available for all chair types, dimensions upon request.
 - 50mm large pipe diameter.
- ◆ **Heavy duty type available**

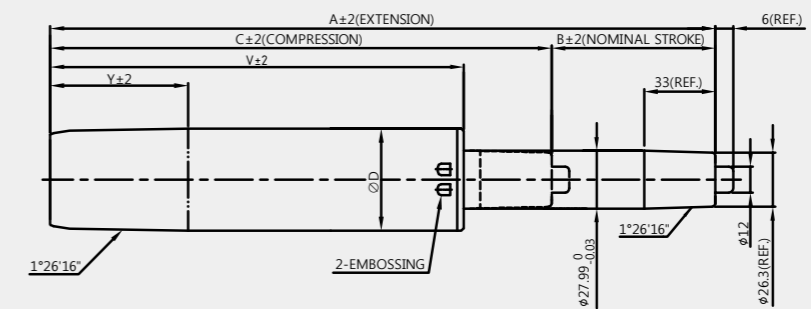

◆ **SGL2 TYPE**

MODEL	DIMENSION(mm)							
	A	B	C	D(Φ)	V	Y	X	F1(N)
SGL2-025-440142BBA	209	17	192	50	142	65	-	400
SGL2-041-440215BBA	303	17	286	50	215	60	-	400
SGL2-070-440205SBA	315	66	249	50	205	157	56	400

◆ **SGL8 TYPE**

MODEL	DIMENSION(mm)							
	A	B	C	D(Φ)	V	Y	X	F1(N)
SGL8-100-430225CBX	290	51	239	50	170	110	56	300
SGL8-070-440205SBX	315	66	249	50	205	157	56	400
SGL8-050-440185CBX	275	42	233	50	185	75	56	400

Non-Rotated Cylinder



N2 TYPE

Z2 TYPE

◆ Features

- Hexagonal outer circumferential surface of profile and inner circumferential surface of bushing.
- Firmly fixed spindle by protrusion on inner circumferential surface of profile.
- Non rotating along the hexagonal guide but operating vertically.
- Smoothly working lift with no noise.

◆ Application

- Small table and stool chairs.

◆ Advantages

- No swivel function.

◆ Dimensions

- Available for all chair types, dimensions upon request.
- 50mm large pipe diameter.

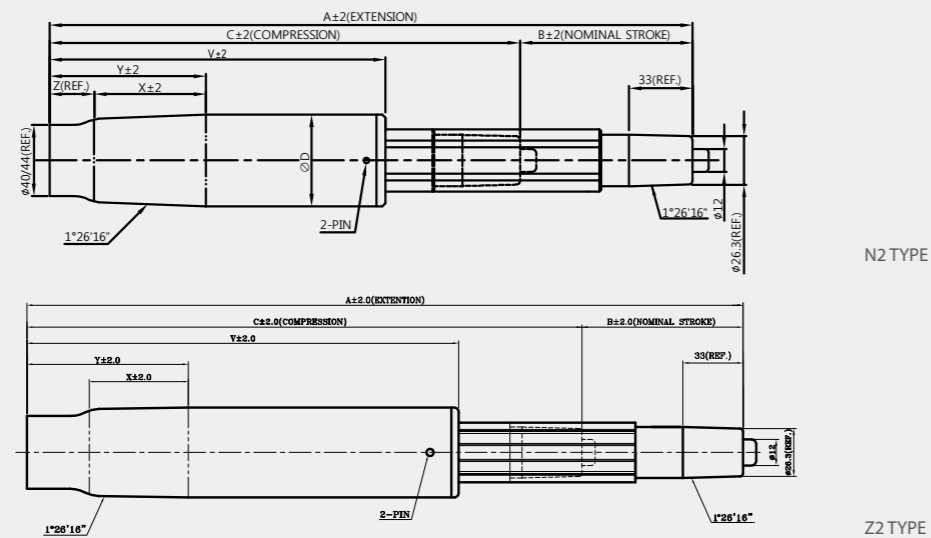

N2 TYPE

Z2 TYPE

◆ SGN2 TYPE

MODEL	DIMENSION(mm)								
	A	B	C	D(Φ)	V	Y	X	Z	F1(N)
SGN2-170-42025CCA	470	162	308	50	255	56	-	-	200
SGN2-270-415370BBB	724	262	462	50	370	85	56	29	150

◆ Z2 Type

MODEL	DIMENSION(mm)								
	A	B	C	D(Φ)	V	Y	Z	F1(N)	
SGZ2-210-430300CCA	554	202	352	50	300	72	-	-	300
SGZ2-250-430350CBA	660	242	418	50	350	65	-	-	300



Dual Mode Cylinder



◆ Features

- Swivel cylinder with locking system for non-rotation feature.
- Easy lever operation converts swivel to non-rotating cylinder.
- Non-rotating locking strength can be retightened by screw adjustment.

◆ Application

- School chairs

◆ Advantages

- Optional rotation upon user's request.

◆ Dimensions

- Due to converting system, size and dimension might be limited.
- Most mid-height chairs can be applied.
- Dimension will be determined upon request.

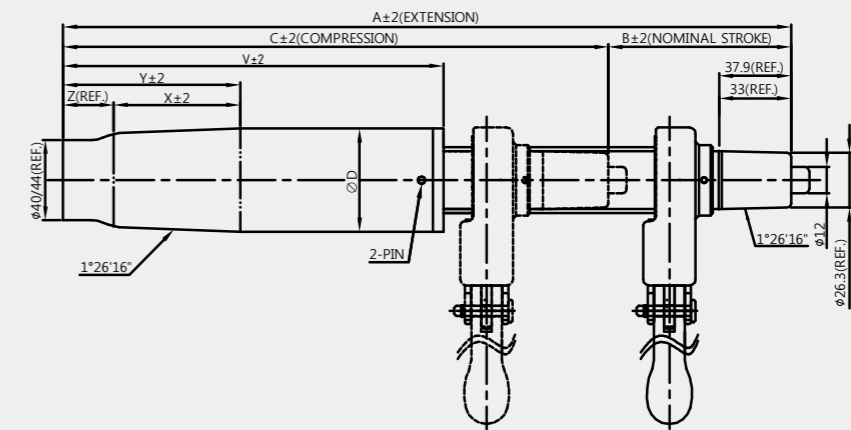

◆ SGN2L TYPE

MODEL	DIMENSION(mm)							
	A	B	C	D(Φ)	V	Y	F1(N)	
SGN2-110L418203BGA	386	98	288	50	203	80	180	
SGN2-110L430203BBA	386	98	288	50	203	80	300	



- ◆ **Features**
 - Large adjustment range with a low bottom seat position without compromising stability and guide properties.
 - Extensive range of stroke in a relatively short length of large pipe.
- ◆ **Application**
 - Able to be applied to a normal chair as well as luxury chair; increases chair's strength and stroke at the same time.
 - Specially designed chair with increased stability and strength.
- ◆ **Advantages**
 - Noise-free and smooth operating.
 - Wobble-free operating.
 - Extensive range of stroke.
- ◆ **Dimensions**
 - Available for all chair types/dimensions upon request.
 - 50mm large pipe diameter.

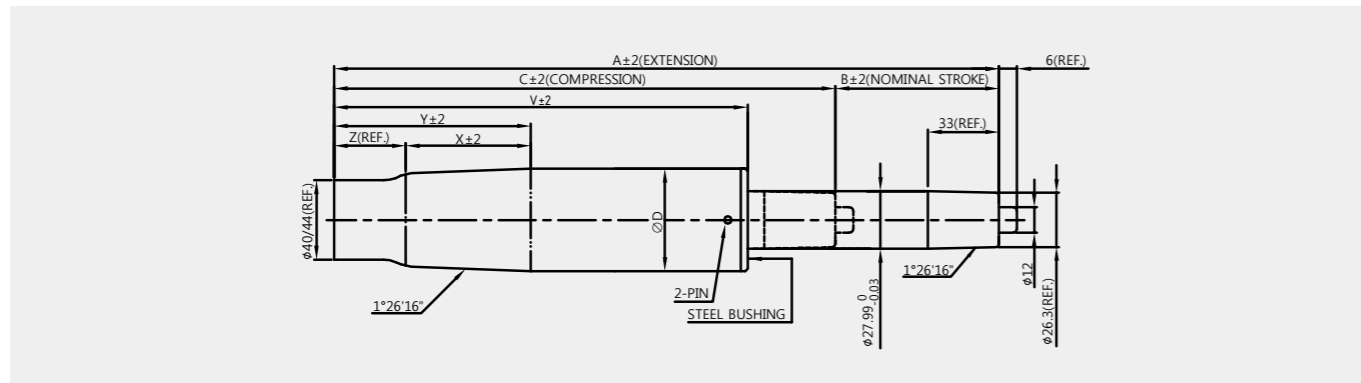

◆ **SGG2 TYPE**

MODEL	DIMENSION(mm)								
	A	B	C	D(Φ)	V	Y	X	Z	F1(N)
SGG2-070-945155CBB	272	66	206	50	155	75	56	19	450
SGG2-094-930175CGA	358	90	266	50	175	120	56	64	300
SGG2-108-935180CBA	349	100	249	50	180	95	56	39	350
SGG2-114-930195SCA	351	110	241	50	195	148	56	92	300
SGG2-118-935205KBB	367	118	232	50	205	101	56	45	350
SGG2-128-935212BBA	387	120	267	50	212	160	56	104	350
SGG2-135-930225CBA	422	131	291	50	225	165	56	109	300
SGG2-270-935370CCA	707	262	445	50	385	72	56	16	350



- ◆ **Features**
 - Large adjustment range with a low bottom seat position without compromising stability and guide properties.
 - Extensive range of stroke in a relatively short length of large pipe.
- ◆ **Application**
 - Able to be applied to a normal chair as well as luxury chair; increases chair's strength and stroke at the same time.
 - Specially designed chair with increased stability and strength.
- ◆ **Advantages**
 - Noise-free and smooth operating.
 - Wobble-free operating.
 - Extensive range of stroke.
- ◆ **Dimensions**
 - Available for all chair types/dimensions upon request.
 - 50mm large pipe diameter.

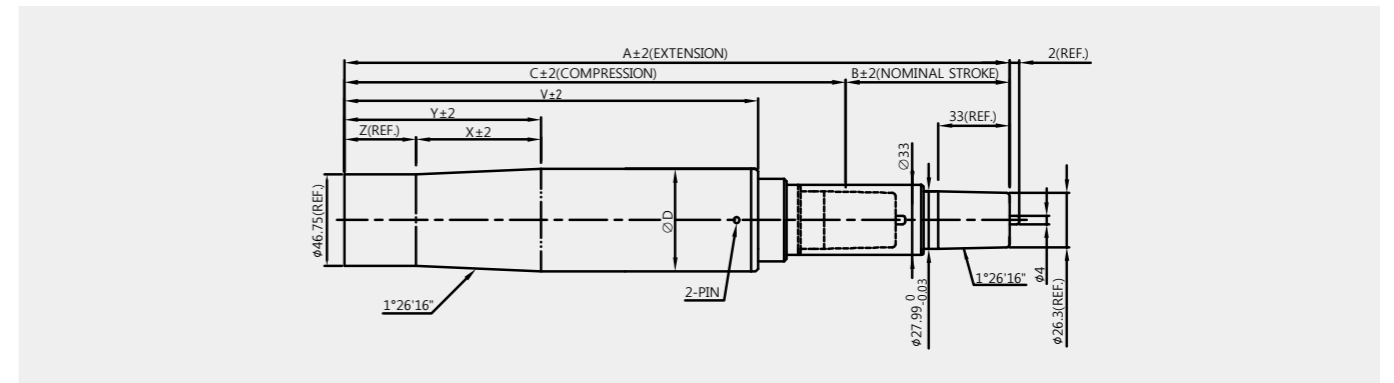

◆ **SGT2 TYPE**

MODEL	DIMENSION(mm)								
	A	B	C	D(Φ)	V	Y	X	Z	F1(N)
SGT2-104-940190BEA	344	100	244	50	190	82	65	17	400
SGT2-125-927175KBA	354	121	233	50	175	115	65	50	270
SGT2-130-930185BBA	371	126	245	50	185	100	56	44	300
SGT2-133-935205KBA	386	129	257	50	205	91	56	35	350
SGT2-147-940192BEA	396	144.5	251.5	50	191.5	101	65	36	400
SGT2-147-940192KEA	390	144.5	245.5	50	191.5	101	65	36	400
SGT2-147-940192KEB	390	144.5	245.5	50	191.5	101	65	36	400
SGT2-147-940223BEA	420	143	277	50	223	82	65	17	400
SGT2-178-435250BBA	465	170	295	50	250	137	56	81	350
SGT2-178-935230BBB	463	174	289	50	230	125	56	69	350
SGT2-230-930290BBA	585	226	359	50	290	100	56	44	300



◆ Features

- Operated by a cable module enabling actuation of the cylinder.
- Minimized assembly dimensions.
- Increased chair design flexibility.

◆ Application

- High performance & advance designed chairs.

◆ Advantages

- Requires comparatively small force to actuate cylinder.
- Optional cable module allows actuation of the cylinders at any position on chair.

◆ Dimensions

- Available for all chair types, dimensions upon request.
- 50mm large pipe diameter.

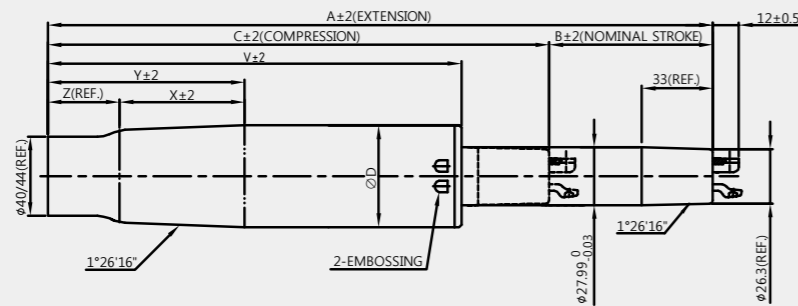

◆ SGS2 TYPE

MODEL	DIMENSION(mm)								
	A	B	C	D(Φ)	V	Y	X	Z	F1(N)
SGS2-104-529190CBA	335	100	235	50.8	190	136	64	72	290
SGS2-123-940192KEA	376	119	253	50	192	98	56	45	400
SGS2-128-430210BBBA	404	124	280	50	210	152	56	96	300
SGS2-128-430210BGA	404	124	280	50	210	152	56	96	300
SGS2-133-435215BBBA	394	129	265	50	215	135	56	79	350
SGS2-143-930237CSA	430	139	291	50	237	101	56	45	300
SGS2-145-430226BBBA	445	141	304	50	226	152	56	96	300
SGS2-147-940197KEA	408	143	265	50	197	98	56	42	400



NO-PIN



STANDARD



SCREW



JOYSTICK



CABLE



ROTATING CABLE

Samhongs
All Taper Cylinder



Standard



All taper

◆ Features

- Taper located in upper area of Large pipe
- Possible using higher base

◆ Application

- Higher based Chair

◆ Advantages

- Flexible chair base design

◆ Dimensions

- Available for all chair types, dimensions upon request.

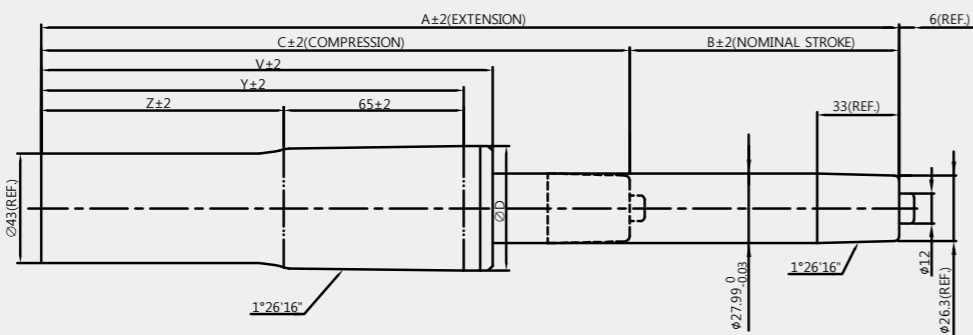

LARGE PIPE : ALL TAPER

MODEL	DIMENSION(mm)								
	A	B	C	D(Φ)	V	Y	X	Z	F1(N)
SGB4-080-440165BBA	298	76	222	50	165	155	65	104	400
SGP2-094-440165CBA	298	86	212	50	165	155	65	104	400

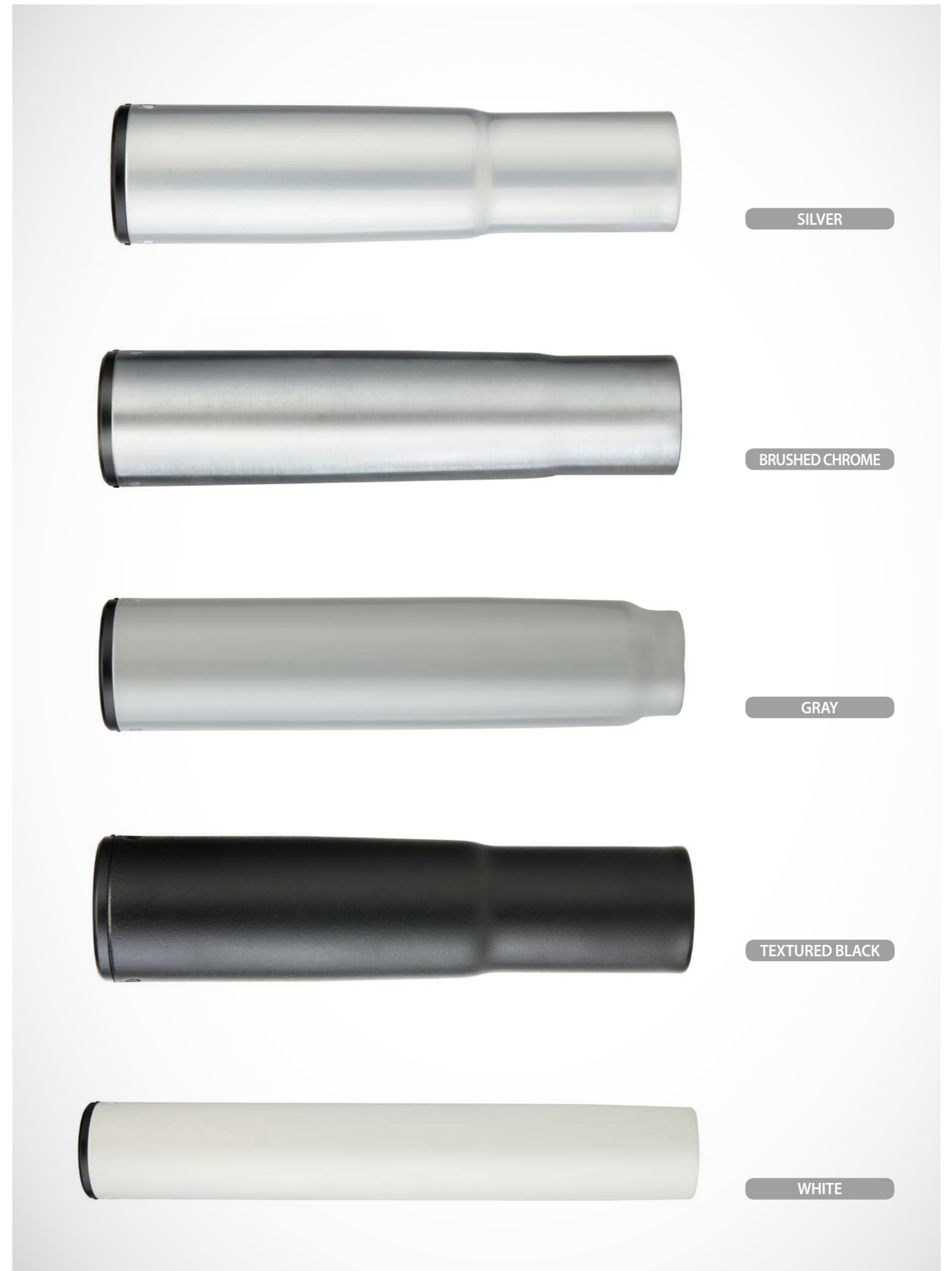

SILVER

BRUSHED CHROME

GRAY

TEXTURED BLACK

WHITE

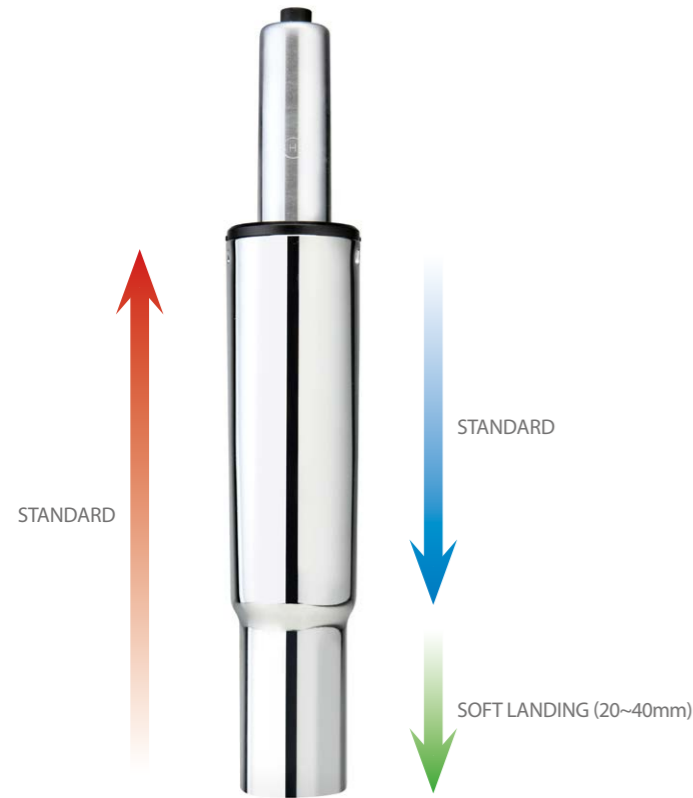

- ◆ **Features**
 - Soft landing by special speed control system at the bottom position(20~40mm).
- ◆ **Application**
 - Conference chairs.
 - Visitors chairs.
- ◆ **Advantages**
 - Shock-free at the bottom position
- ◆ **Dimensions**
 - Available for all chair types, dimensions upon request.

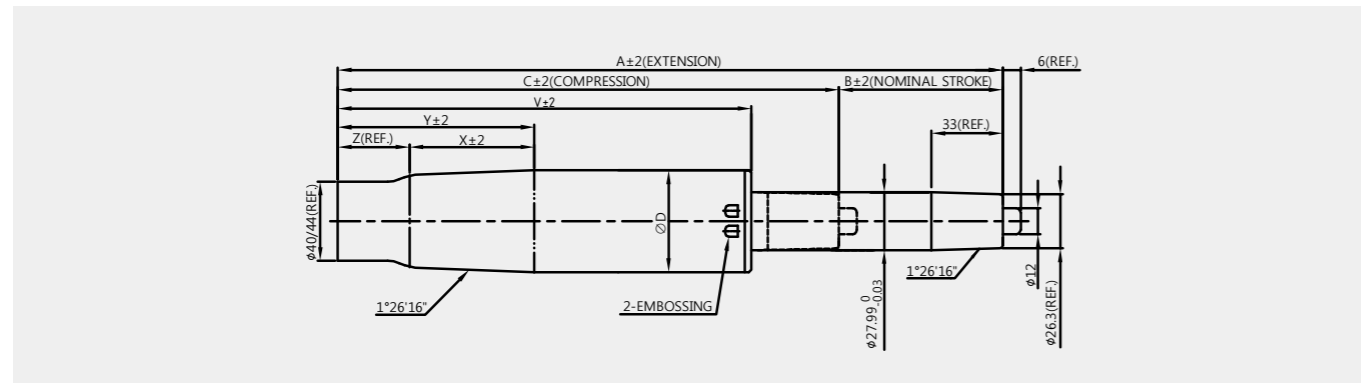

◆ **SGB2KTYPE**

MODEL	DIMENSION(mm)								
	A	B	C	D(Φ)	V	Y	X	Z	F1(N)
SGB2K080-440187CBA	306	72	234	50	187	75	56	19	400
SGB2K120-440205CCA	384	112	272	50	205	123	56	87	400
SGB2K125-440210CCA	389	121	268	50	210	90	-	-	400



- ◆ **Features**
 - Slowly drop down by special speed control system over the entire stroke.
 - Standard lifting speed.
- ◆ **Application**
 - Conference chairs.
 - Visitors chairs.
- ◆ **Advantages**
 - Silent operation during compression.
- ◆ **Dimensions**
 - Available for all chair types, dimensions upon request.

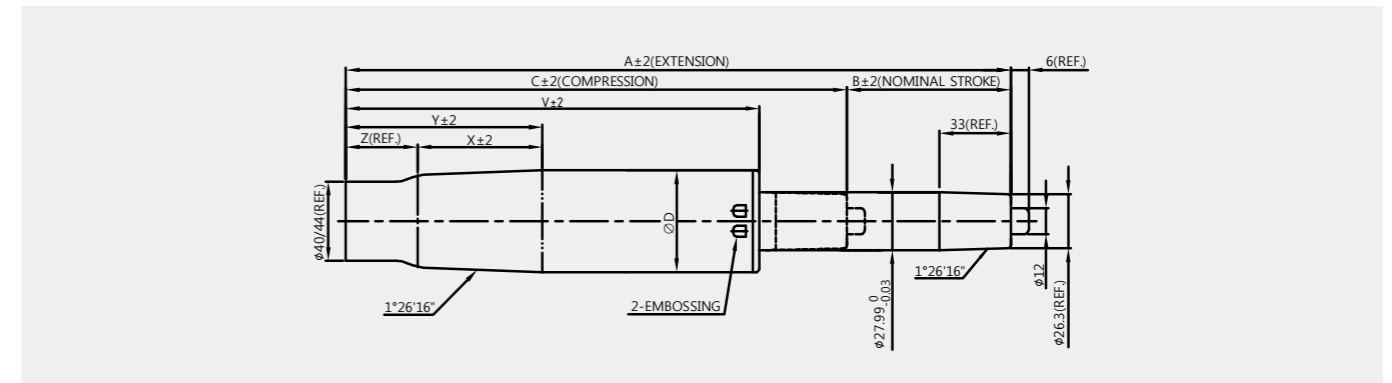

◆ **SGB2STYPE**

MODEL	DIMENSION(mm)								
	A	B	C	D(Φ)	V	Y	X	Z	F1(N)
SGB2-080S440187BBA	321	76	245	50	187	105	56	49	400
SGB2-128S440215BBA	384	120	264	50	215	105	56	49	400
SGB2-200S440315BBA	572	196	376	50	315	105	56	49	400
SGB2-270S945370BBA	702	262	440	50	370	105	56	49	450



- ◆ **Features**
 - Combination of Bouncing and Deep cushion cylinder
 - Comfortable seating over the entire stroke as well as in the lowest seating position.
- ◆ **Application**
 - Specially designed soft chair for comfort at any position.
- ◆ **Advantages**
 - Smooth seating comfort for entire seated period due to specially designed bouncing spring.
 - Coil spring structure.
 - Additional deep-cushioning function.
- ◆ **Dimensions**
 - Available for all chair types, dimensions upon request.

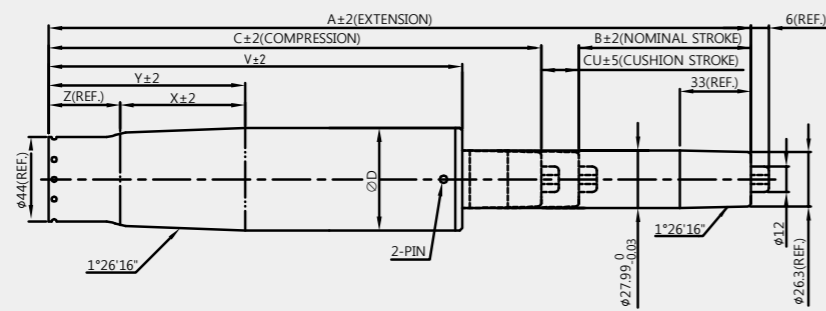

◆ **SGX2E TYPE**

MODEL	DIMENSION(mm)									
	A	B	C	CU	D(Φ)	V	Y	X	Z	F1(N)
SGX-130E430210BBA	396	108.5	287.5	14	50	210	118	78	40	300
SGX-125E435220CBX	391	103.5	287.5	14	50	220	115	78	37	350



- ◆ **Features**
 - Comfortable seating at the lowest seating position.
- ◆ **Application**
 - Specially designed soft chair for comfort at lowest seating position.
- ◆ **Advantages**
 - Smooth seating comfort for seated period due to specially designed deep-cushion spring.
- ◆ **Dimensions**
 - Available for all chair types, dimensions upon request.

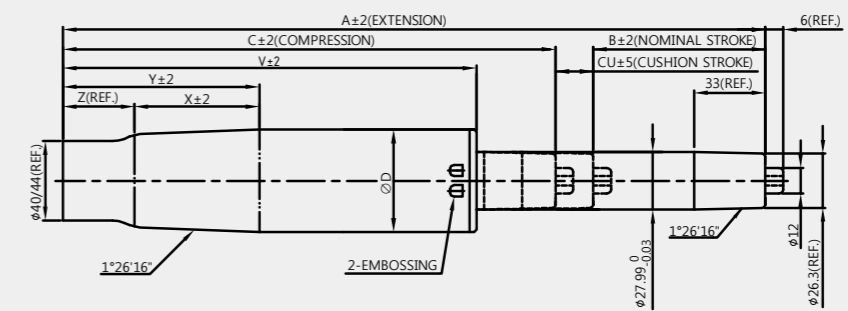

◆ **SGB2E TYPE**

MODEL	DIMENSION(mm)									
	A	B	C	CU	D(Φ)	V	Y	X	Z	F1(N)
SGB2-096E430185BBA	331	91	240	12	50	185	95	56	39	300
SGB2-128E430210BBA	384	124	260	12	50	210	183	56	127	300
SGB2-143E435220CBA	419	127	280	12	50	220	80	56	24	350

Samhongs
Bouncing Cylinder



- ◆ **Features**
 - Comfortable seating over the entire stroke as well as in the lowest seating position.
- ◆ **Application**
 - Specially designed soft chair for comfort at any position.
- ◆ **Advantages**
 - Smooth seating comfort for entire seated period due to specially designed bouncing spring.
 - Coil spring structure.
- ◆ **Dimensions**
 - Available for all chair types, dimensions upon request.
 - 50mm large pipe diameter.

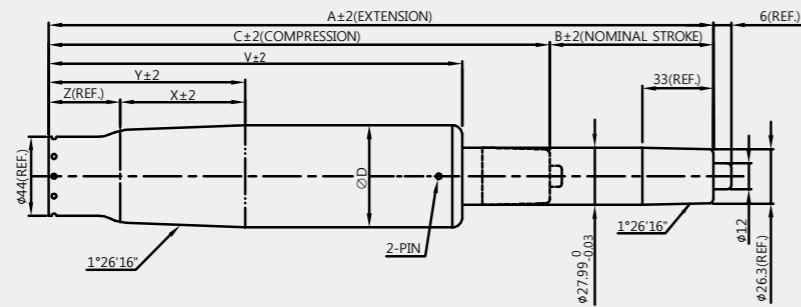

◆ **SGX2 TYPE**

MODEL	DIMENSION(mm)									
	A	B	C	D(Φ)	V	Y	X	Z	F1(N)	
X2-108-430190CBA	361	100	261	50	190	97	56	41	300	
X2-108-430200CBA	376	100	276	50	200	97	56	41	300	
X2-108-430250CBA	422.5	100	322.5	50	250	97	56	41	300	
X2-108-445190CBA	361	100	261	50	190	97	56	41	450	
X2-108-445200CBA	376	100	276	50	200	97	56	41	450	
X2-108-445200CCA	376	100	276	50	200	97	56	41	450	
X2-108-445300CBA	520.5	100	420.5	50	300	97	56	41	450	
X2-118-440200BBA	371.5	111	261.0	50	200	137	78	59	400	
X2-110-430265CBA	439	102	337	50	265	97	56	41	450	
X2-110-445265CBA	439	102	337	50	265	97	56	41	300	
X2-130-430210BBA	397.5	122.5	275	50	210	150	78	72	300	
X2-138-430245BBA	438.5	130.5	308	50	245	157	78	79	300	

Tiny Cylinder



- ◆ **Features**
 - The shortest cylinder
 - Non-height adjustable
- ◆ **Application**
 - Lounge chairs
- ◆ **Advantages**
 - Wobble-free operating



THIS IS REAL SIZE

MODEL : SGT6-6000-40060CCA

Long Cylinder

- ◆ **Features**
 - The longest cylinder
 - Height adjustable
- ◆ **Application**
 - Bar chairs
 - Sit-Stand chairs
- ◆ **Advantages**
 - Extremely long stroke

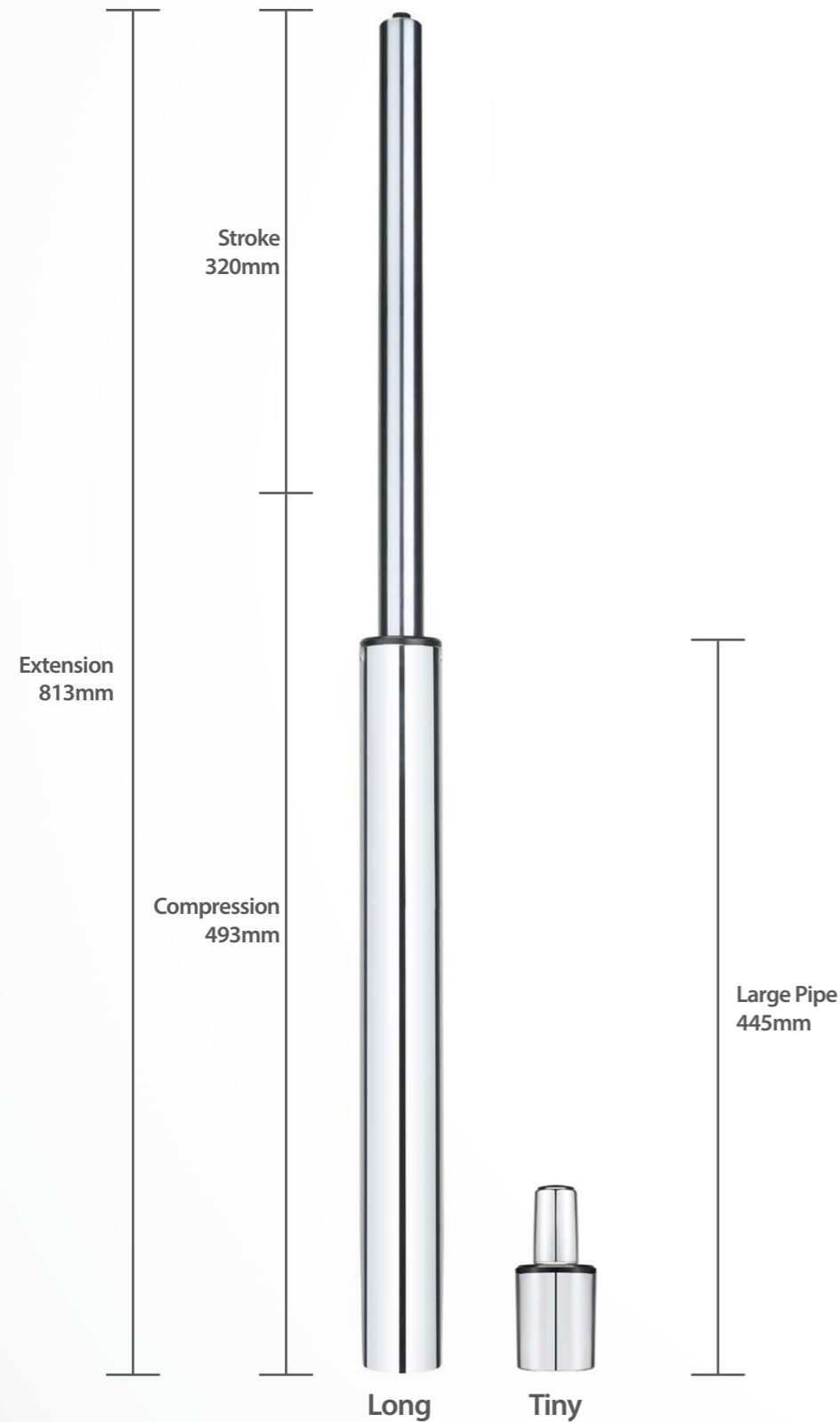
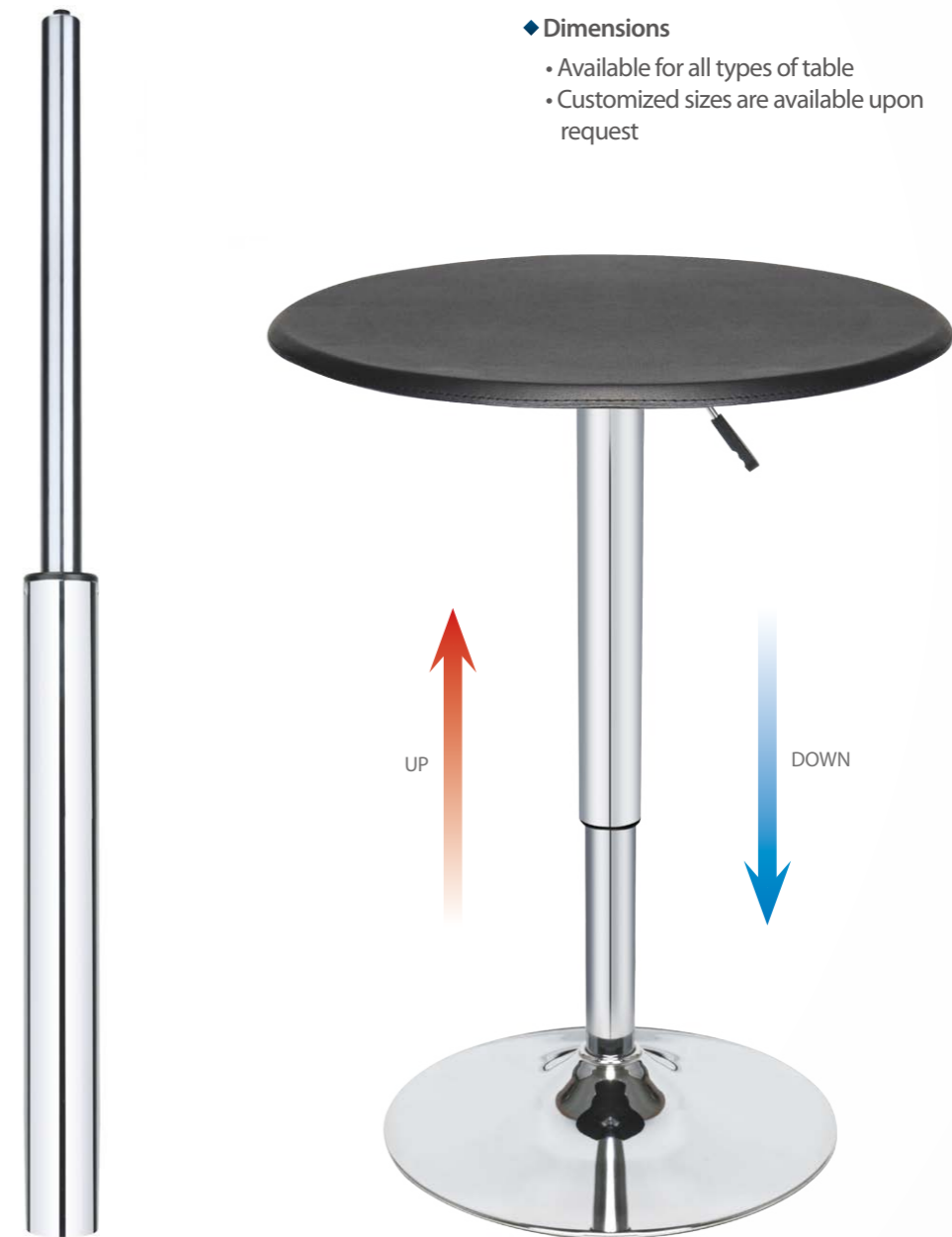

Table Cylinder

- ◆ **Features**
 - Rigid stabilization with low gas pressure (even with heavy load)
 - Longer stroke length compared to other gas cylinders
- ◆ **Application**
 - Side tables, lounge tables
- ◆ **Advantages**
 - Easy assembly
 - Prevent the rotation with non rotate table cylinder
- ◆ **Dimensions**
 - Available for all types of table
 - Customized sizes are available upon request



DIMENSION(mm)				
A	B	V	D(Φ)	F1(N)
844	350	451	50	120 or more

* Customized sizes are available upon request